

FILTERS

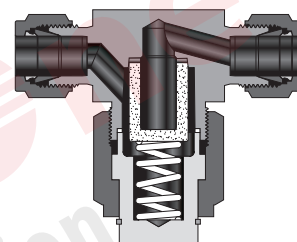

FA Series

- ♦ Filter element replaceable without removing body from system
- ♦ Nominal pore sizes for sintered element: 0.5, 2, 7, 15, 40, 60 and 90 μm
- ♦ Nominal pore sizes for strainer element: 100, 150, 250 and 450 μm
- ♦ Working pressure up to: 6000 psig (414 bar)
- ♦ Working temperature: -20°F to 900°F (-28°C to 482°C)
- ♦ Variety of end connections available



FB Series

- ♦ Bypass port at filter bottom for the ease of sampling or purging
- ♦ Nominal pore sizes for sintered element: 0.5, 2, 7, 15, 40, 60 and 90 μm
- ♦ Nominal pore sizes for strainer element: 100, 150, 250 and 450 μm
- ♦ Working pressure up to: 6000 psig (414 bar)
- ♦ Working temperature: -20°F to 900°F (-28°C to 482°C)
- ♦ Variety of end connections available

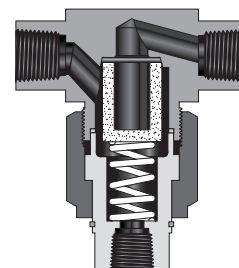

FW Series

- ♦ Large filtration area and high flow coefficient
- ♦ All-welded construction for elimination of leakage
- ♦ Easy cleaning of filters by backflushing
- ♦ Nominal pore sizes for sintered element: 0.5, 2, 7, 15, 40, 60 and 90 μm
- ♦ Working pressure up to: 6000 psig (414 bar)
- ♦ Working temperature: -20°F to 900°F (-28°C to 482°C)
- ♦ Variety of end connections available

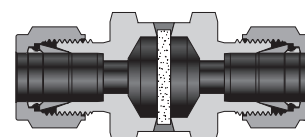

F Series

- ♦ Compact and space-saving design
- ♦ Nominal pore sizes for sintered element: 0.5, 2, 7, 15, 40, 60 and 90 µm
- ♦ Nominal pore sizes for strainer element: 100, 150, 250 and 450 µm
- ♦ Working pressure up to: 207 bar (3000 psig)
- ♦ Working temperature: -20°F to 900°F (-28°C to 482°C)
- ♦ Variety of end connections available

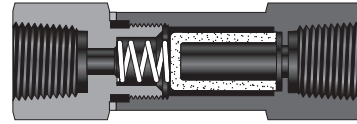

Ordering Number Description

A B C D E F G H I J K
SS - FB - F 8 - M 10 - L - 7 - F2 -S-W

A	Body Material
SS=316 SS	
4S=304 SS	
21S=321 SS	
904L=904L SSS	
6L=316L SS	
M=Alloy 400	
B=Brass	

B	Series
FA Series	
FB Series	
F Series	
FW Series	

C	P1 Type
M=Metric Ferrule	
F=Fractional Ferrule	
FN=NPT female tapered threads	
N=NPT male tapered threads	
FRT=ISO tapered female threads	
RT=ISO tapered male threads	
FRP= Inch parallel female threads (suitable for RP gasket)	
BP=ISO parallel male threads (suitable for RG gasket)	
FMS=Metric female threads (suitable for RG gasket)	
MS=Metric male threads (suitable for RG-M gasket)	

D	P1 Size
2=1/8"	
3=3mm	
4=1/4"	
6=3/8" (6mm)	
8=1/2" (8mm)	
10=5/8" (10mm)	
12=3/4" (12mm)	
16=1" (16mm)	
20=1 1/4" (20mm)	
M20x1.5	
25=25 mm	

E F	P2 Type/Size
	Specify in the same way as the P1

G	Cartridge form
	Default = Sintered type
	L= Filter screen type

H	Filter element accuracy
	0.5=0.5µm
	2=2µm
	7=7µm
	15=15µm
	40=40µm
	60=60µm
	80=80µm
	100=100µm
	150=150µm
	250=250µm
	450=450µm

I	Bypass port form and size
	Default = 1/8" NPT female thread
	F2=1/8" sleeve connector
	F4=1/4" sleeve connector
	F8=1/2" sleeve connector

J	Special Application
	Default = None
	S=NACE MR 0175

K	Cleaning and Packaging
	Default = Standard cleaning and packaging for general industrial use
	W=Degreasing
	W2=Oxygen-rich cleaning

QUICK-CONNECTS

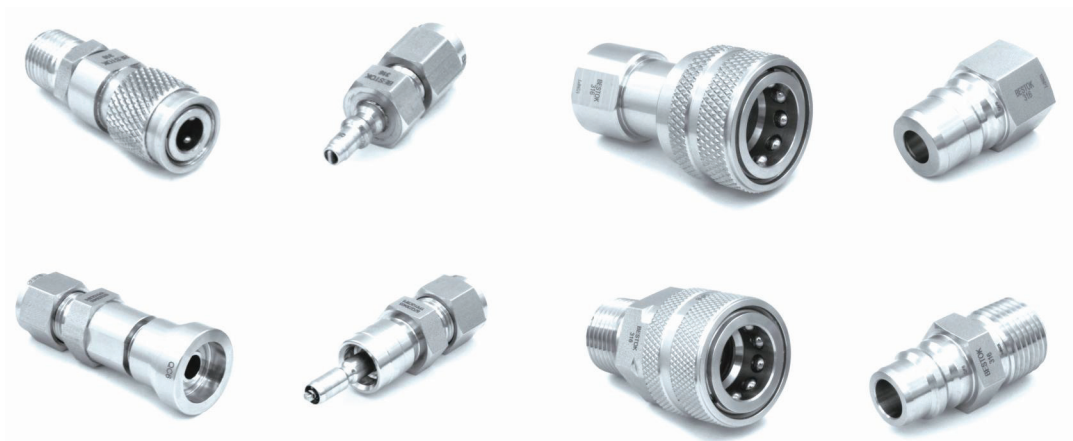

QC Series

- ♦ Working pressure up to: 3000 psig (207 bar)
- ♦ Working pressure up to:
- ♦ Simple push-to-connect coupling for quick and easy operation
- ♦ Sturdy locking mechanism with large contact area to ensure reliable stem retainment
- ♦ Reliable, leak-tight O-ring seals for vacuum or pressure systems
- ♦ Mix-interchangeable with other main brands
- ♦ Single-end shutoff, double-end shutoff and full-flow quick-connects available
- ♦ Large area contacted bead locking tube/pipe diameter.
- ♦ End connections: 1/8" to 1/2" NPT, 1/8" to 1/2" and 6 mm to 12 mm tube fitting and 1/4" to 1/2" hose connector

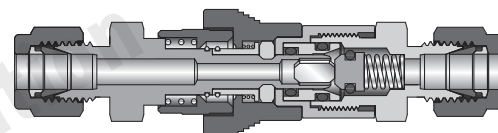

QF Series

- ♦ Full path, large flow
- ♦ Quick, easy operation
- ♦ Working pressure up to: 6000 psig (414 bar)
- ♦ Materials: stainless steel or brass
- ♦ A smooth, open chamber with no valves at either end minimizes pressure drop and is easy to clean.
- ♦ End connections: 1/4" to 1" NPT, 1/4" to 1" and 6 mm to 25 mm tube fitting

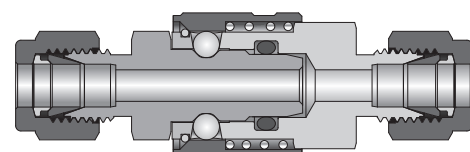

← two-way flow →

QM Series

- ♦ Maximum working pressure up to 4000 psig (276 bar)
- ♦ Materials: stainless steel or brass
- ♦ Single-end shutoff, double-end shutoff and full-flow available
- ♦ Quick, easy operation
- ♦ Micro quick connector

